



# **Making an Impact**

## **11th National Conference of Emerging Researchers in Ageing**

# **Conference Program**

**19-20 November 2012**  
**The Greek Club, Brisbane, Australia**  
**[www.uq.edu.au/bluecare/era-2012](http://www.uq.edu.au/bluecare/era-2012)**



# **Making an Impact**

## **Conference Program**

### **The 11th National Conference of Emerging Researchers in Ageing**

**19 & 20 November 2012  
The Greek Club, Brisbane, Australia**

*Presented by*



*Sponsored by*



# Welcome

---



It is with great pleasure that I welcome you to the 11th National Conference of Emerging Researchers in Ageing. This conference builds on a long history of successful ERA conferences hosted around Australia. This year The University of Queensland/Blue Care Research and Practice Development Centre is hosting ERA 2012 in Brisbane. This seems fitting as 10 years ago the inaugural ERA conference was held in Brisbane at The University of Queensland. This year we have chosen the Greek Club as our central location at South Bank and hope you have the opportunity to visit local venues and enjoy the fabulous Queensland weather. We have chosen the dates to coincide with the Australian Association of Gerontology conference which will also be hosted at South Bank and hope you might take the opportunity to immerse yourself in an entire week celebrating ageing research in Australia.

Like previous years this conference has an extensive program bringing together students from a broad range of research areas to discuss and share the latest research on ageing. We have chosen the theme of *Making an Impact*, which focuses on the policy and practice implications of research. It emphasises the impact that the work of emerging researchers has on the field of ageing and the potential their research holds for influencing change. We have 46 oral presentations, 6 posters and 16 full papers. On the second day we are pleased to present 2 workshops - *Building a career in ageing: beyond the PhD* and *Issues in mixed methods research*. The workshop Building a career in ageing is coordinated by Dr Tim Henwood, who is a Research Fellow at the UQ/Blue Care Research & Practice Development Centre. The mixed method workshop also has a local UQ host with Dr Deirdre McLaughlin, Senior Research Fellow, Centre for Longitudinal and Lifecourse Research. I know those attending will really enjoy the opportunity to work in a small group environment and continue the networking that will be a feature of the first day of the conference.

I would like to thank our generous sponsors Wesley Mission Brisbane, The Australian Association of Gerontology, National and Queensland Division and our industry partner Blue Care.

So once again, welcome to ERA 2012. Enjoy yourself and I look forward to meeting you and hearing about the latest fantastic developments in ageing research.



Deborah Parker  
Director  
UQ/Blue Care Research and Practice Development Centre  
School of Nursing and Midwifery  
University of Queensland

# Acknowledgements

---

We would like to thank our generous sponsors for ERA 2012:

- Wesley Mission Brisbane, Gold Sponsor;
- The Australian Association of Gerontology, Silver Sponsor;
- Blue Care; and
- The Australian Association of Gerontology, Queensland Division.

The conference committee for ERA 2012 included: Associate Professor Deborah Parker (Convenor), Dr Andrea Petriwskyj, Vicki Percival, Dr Matthew Carroll, Dr Tim Henwood, Dr Anthony Tuckett and Sue Hunt. We would also like to thank former ERA staff member Barbara Dungey.

A number of academics and students volunteered their time to review abstracts and papers and help out on the day of the conference—many thanks to all of them.

# Keynote Speakers

---



**Professor Wendy Moyle**

Director, Research Centre for Clinical and Community Practice Innovation

*"Mapping and advancing your career from ECR to experienced researcher"*

Professor Moyle is an internationally renowned expert on care for older people and people with dementia. The focus of her work has been on quality of life and finding evidence for managing agitated behaviours in people living with dementia using controlled trials and psychosocial and complementary and alternative medicine interventions. As the Director of a large and successful research centre she has successfully mentored a number of successful researchers.

In her presentation, Prof Moyle will discuss opportunities available to build your career post PhD. She will use examples from her own career and of those she has mentored to demonstrate structures and supports necessary to help advance your career.



**Dr Tony Coles**

Executive Officer, Australian Association of Gerontology

*"Opening doors to new opportunities"*

Prior to taking up the position of Executive Officer with the AAG, Dr Coles worked for three years with the Australian Government Department of Health and Ageing, initially within the graduate program before being promoted to acting Assistant Director with the Office for an Ageing Australia (OFAA). Dr Coles has also worked as a lecturer and tutor at the University of Tasmania and the University of Helsinki, Finland.

In his presentation, Dr Coles will discuss the importance of postgraduate education in relation to career development, the opportunities available to those looking at a career beyond academics after graduation, and the advantages of focusing on ageing in terms of both research and career. Drawing on his own experiences in academics, government, and the not-for-profit sector, Dr Coles will highlight the varied opportunities available to emerging researchers in ageing, and how postgraduates with expertise in ageing are able to make an impact across the broader work spectrum.

# Conference Program

---

**Monday 19 November 2012**

**8:00 – 9:00**

**Registration**

**9:00 – 10:10**

**Opening Plenary**

Aegean Room

**Opening and Welcome**

**Associate Professor Deborah Parker**

Conference Convener

**Dr Matthew Carroll**

ERA Coordinator

**Message from our Gold Sponsor**

**Judy Wollin**

Wesley Mission Brisbane

**Keynote Address**

*“Mapping and advancing your career from ECR to experienced researcher”*

**Professor Wendy Moyle**

Director, Research Centre for Clinical and Community Practice Innovation  
and Unit Leader - Ageing and Older People Unit, Research Centre for Clinical  
and Community Practice Innovation

**10:10 – 10:40**

**Morning Tea and poster viewing**

Aegean Room

# Conference Program

	Session A	Session B	Session C
10:40 – 12:00	<b>Pain and Chronic Disease</b> Aegean Room Chair: Adam Burston	<b>Social and Experiential Dimensions</b> Ionian Room 1 Chair: Fengsong Gao	<b>Dementia and Depression</b> Ionian Room 2 Chair: Katrina Radford
	<p>Barriers and facilitators to pain identification and assessment in older people with moderate to severe dementia living in residential aged care <b>Helen Holloway</b></p> <p>Healthcare costs of arthritis: A systematic review of published studies <b>Thomas Lo</b></p> <p>A cross sectional survey of pain in older women <b>Katie DeLuca</b></p> <p>The assessment and management of pain in older people in acute care: What are the barriers and/or facilitators to the practice of nurses? <b>Joanne Harmon</b></p> <p>A qualitative exploration of current smokers' views on smoking cessation among Greek-Australian elderly people aged 50 and over <b>Masoud Mohammednezhad</b></p>	<p>Representations of age and ageing in comedy film <b>Margaret Gatling</b></p> <p>Speaking of farming: Narrative ethnography of the ageing self <b>Zoe O'Callaghan</b></p> <p>Successful ageing in Asia and the Pacific <b>Nicamil Sanchez</b></p> <p>The exploration of perceptions of quality of life among older Chinese immigrants in the Australian Capital Territory (ACT) <b>Christine Wu</b></p> <p>Preserving the priceless: An exploratory study of volunteerism in heritage transport museums <b>Sandra Bateman</b></p> <p>Advocacy in rural residential aged care facilities <b>Robyn Collins</b></p>	<p>Choir therapy as a psychotherapeutic intervention for reducing depression in mid to later age <b>Kirstin Robertson-Gillam</b></p> <p>The experience and meaning of a first-time diagnosis of depression for rural older people <b>Sandra Davidson</b></p> <p>Barriers to diagnosing dementia in rural general practice <b>Angela Greenway-Crombie</b></p> <p>Early intervention with people with dementia: Is it what they want? <b>Gillian Stockwell-Smith</b></p> <p>Falls prevention knowledge translation for community-dwelling people with dementia <b>Claudia Meyer</b></p> <p>Appraisal of the quality of care in older people with cognitive impairment presenting to emergency departments <b>Linda Schnitker</b></p>
12:00 – 1:00	<b>Lunch and poster viewing</b> Aegean Room		

# Conference Program

	Session D	Session E	Session F
	<b>Aged Care Workforce</b>	<b>Evidence-Based Practice</b>	<b>Housing and Resources</b>
1:00 – 2:20	Aegean Room Chair: Jennifer Hewitt	Ionian Room 1 Chair: Helen Holloway	Ionian Room 2 Chair: Hamish Robertson
	<p>Attraction and retention of residential aged care workers in Australia <b>Fengsong Gao</b></p> <p>The effects of personal and organisational resources on eldercare strain: A longitudinal study <b>Claire Greaves</b></p> <p>Evaluating the knowledge of nursing assistants in a palliative approach <b>Sara Karacsony</b></p> <p>The Australian aged care nurse: Improving workplace satisfaction and staff retention <b>Adam Burston</b></p> <p>Battle of the decades: Factors affecting different generations of employees' intentions to stay in and leave the aged care sector <b>Katrina Radford</b></p>	<p>A grounded theory study of evidence-based practice in residential aged care <b>Malcolm Masso</b></p> <p>Shining a light on night-time continence care in residential aged care facilities <b>Joan Ostaszkiewicz</b></p> <p>The impact of innovative research methods in complex settings <b>Janice Taylor</b></p> <p>Identification of early predictors of non-healing venous leg ulcers after 24 weeks <b>Christina Parker</b></p> <p>Validation of decision support software for identification of drug-related problems in home medicines reviews <b>Colin Curtain</b></p>	<p>Home equity release products allowing for individual house price risk <b>Adam Wenqiang Shao</b></p> <p>Retirement and asset allocation in Australian households <b>Megan Gu</b></p> <p>Transportation - implications for accessibility for older people <b>Elisabeth Zeitler</b></p> <p>The effect of tax incentives on participation in salary sacrificing into superannuation <b>Jun Feng</b></p> <p>Exploring the experience of food insecurity for older Australians through phenomenology and ethnography <b>Alexandra King</b></p> <p>Housing security in later life <b>Deborah Oxlade</b></p>
2:20 – 2:50	<b>Afternoon Tea and poster viewing</b> Aegean Room		

# Conference Program

	Session G	Session H	Session I
<b>2:50 – 4:00</b>	<b>Health Service Use and Planning</b> Aegean Room Chair : Deborah Oxlade	<b>Family and Carers</b> Ionian Room 1 Chair: Sandra Davidson	<b>Biological and Physiological Ageing</b> Ionian Room 2 Chair: Claudia Meyer
	<p>Understanding the social determinants of older men's health  <b>Luckman Hlambelo</b></p> <p>Modeling demand driven provision of formal aged care for baby boomers in Australia  <b>Sarah Yu</b></p> <p>Use of home and community care services by older Chinese immigrants in Australia  <b>Dolly Huang</b></p> <p>Making an impact on ageing from space: A multidimensional approach  <b>Hamish Robertson</b></p> <p>Medications use and mental health outcome  <b>Maha Alsalami</b></p>	<p>Lived experiences after a spouse's admission for permanent care  <b>Lisa Hee</b></p> <p>Many ways of knowing: Using multiple methods to explore care giving  <b>Belinda Cash</b></p> <p>Care giving burden for Taiwanese caregivers looking after people with dementia  <b>Wu (Chloe) Shunting</b></p> <p>The development of an appropriate model of pastoral care to address the challenges for family carers of people with dementia  <b>Di Crowther</b></p>	<p>Macronutrient regulation, metabolic health and ageing in mice  <b>Samantha Solon</b></p> <p>Falls prevention in residential aged care - making an impact - by averting impact!  <b>Jennifer Hewitt</b></p> <p>Immunomodulatory and genoprotective function of polyphenols from cassia auriculata flowers on aged rat model  <b>Cini John</b></p> <p>A randomised controlled trial investigating the effect of additional exercise for bed based transition care program clients  <b>Carol Parker</b></p>
<b>4:00 – 5:00</b>	<p><b>Closing Plenary</b>                      Aegean Room</p> <p><b>Keynote Address</b>  <i>"Opening doors to new opportunities"</i>  <b>Dr Tony Coles</b>                      Executive Officer, Australian Association of Gerontology</p> <p><b>Announcement of Prizes</b></p> <p><b>Introduction to the ERA 2013 Conference</b>  <b>Dr Matthew Carroll</b>                      ERA Coordinator</p> <p><b>Closing</b></p>		
<b>5:00–6:30</b>	<p><b>Conference Reception</b>                      Greek Club Terrace</p>		

# Conference Program

---

**Tuesday 20 November 2012**

## Conference Workshops

<b>9:00 - 10:30</b>	<b>Issues in mixed-methods research</b> Acropolis Room 1	<b>Building a career in ageing: Beyond the PhD</b> Acropolis Room 2
<b>10:30 - 11:00</b>	<b>Morning Tea</b> Acropolis Room 1	
<b>11:00 - 12:30</b>	<b>Issues in mixed-methods research</b> Acropolis Room 1	<b>Building a career in ageing: Beyond the PhD</b> Acropolis Room 2
<b>12:30</b>	<b>End of post-conference workshops</b>	

# Posters

---

Posters will be displayed throughout Monday, 19 November 2012 in the Aegean Room. Delegates are encouraged to take time during the tea and lunch breaks to view the posters and meet the authors.

No	Title	Authors
1	Impact of chronic disease on workforce participation	<i>Tazeen Majeed, Julie Byles, Peta Forder</i>
2	How is the experience of pain measured in older, community dwelling people with arthritis?	<i>Katie DeLuca, Lynne Parkinson, Julie Byles, Fiona Blyth, Henry Pollard</i>
3	Serum induced SIRT1 expression in older men	<i>David Le Couteur, Shajjia Razi, Vicky Benson, Vasi Naganathan, Victoria Cogger</i>
4	Behavioural smoking cessation programs targeted to elderly people: A systematic review	<i>Masoud Mohammednezhad, Paul Ward, George Tsetuor, Carlene Wilson, Julie Ratcliff</i>
5	Development and pilot of a survey instrument for measuring pain in older women with arthritis	<i>Katie DeLuca, Lynne Parkinson, Julie Byles, Fiona Blyth, Henry Pollard</i>
6	The relationship between diet and age-related changes in liver sinusoidal endothelial cells	<i>Mashani Mohamad, Victoria Cogger, Samantha Solon, Aisling McMahon, Steve Simpson, David Le Couteur</i>

# Conference Workshops

---

## **Mixed Methods Research: A natural complement to qualitative and quantitative research**

### **Dr Deirdre McLaughlin**

Senior Research Fellow

Centre for Longitudinal and Lifecourse Research, School of Population Health,  
The University of Queensland

'Mixed methods' research has become increasingly accepted in recent years because of the capacity to use both qualitative and quantitative research methods in order to develop a deeper understanding of a topic. Combining analysis strategies, however, raises a number of issues. This workshop will provide emerging researchers with a general understanding of how to conduct mixed methods research and of the challenges and opportunities associated with it.

## **Building a career in ageing: Beyond the PhD**

### **Dr Tim Henwood**

Research Fellow

UQ/Blue Care Research & Practice Development Centre, School of Nursing and Midwifery,  
The University of Queensland

This workshop will provide emerging researchers with insights regarding how to successfully transition into a career in ageing. The workshop will involve a panel of recent PhD graduates and emerged researchers now working in a variety of fields, including academic, clinical, government, private industry and the not-for-profit sector. Students will have the opportunity to ask panel members about their PhD experiences, managing workloads, identifying mentors, and developing career paths.



## Partner with Wesley Mission Brisbane for Clinical and Research Opportunities

Wesley Mission Brisbane (WMB) is an agency of the Uniting Church in Australia celebrating 105 years of community service and aged care in 2012. WMB's facilities and programs extend across Brisbane suburbs and the South East Queensland region offering residential care, independent housing and community care in the home for aged people. Community service programs include emergency relief, disability and employment programs, support for disengaged youth, youth-at-risk and young parents, family day care schemes and child care centres. In addition, the National Auslan Booking Service provides interpreting services for the Deaf community across Australia. With around 2300 staff and 800 volunteers WMB offers support and assistance for Queenslanders who need it.

We are at the beginning of our research journey and a potential partner in your research.

### **Post graduate clinical research opportunities are available in:**

- Aged Care
- Retirement Living
- A diverse range of community research settings including child care, youth, family and health indicators.

### **Wesley Mission Brisbane has been awarded research grants:**

- ARC Linkage Grant - Playful engagement and dementia: understanding the efficacy of applied theatre practices for people with dementia in residential aged care facilities.
- End of Life Care Pathways - Round 5 of the Department of Health and Ageing - Local Palliative Care Grants Program.

### **Wesley Mission Brisbane offers:**

- a workplace that values diversity and an environment that promotes and rewards learning and career development
- salary packaging
- education and professional development programs
- career pathways and internal promotional opportunities
- work part-time while completing your research.

Wesley Mission Brisbane is the first residential aged care community in Queensland to achieve full registration with Eden in Oz & NZ® and winner of two Better Practice Awards from the Aged Care Standards and Accreditation Agency.

[www.wmb.org.au](http://www.wmb.org.au)

### **For more information contact:**

#### **Prof Judy Wollin**

RN, Grad Dip App Sc, BA (SSci),  
MAppSci, PhD

E: [j.wollin@wmb.org.au](mailto:j.wollin@wmb.org.au)



## THE UNIVERSITY OF QUEENSLAND/BLEUCARE RESEARCH & PRACTICE DEVELOPMENT CENTRE

The UQ School of Nursing and Midwifery and Blue Care have forged a formal academic link and developed The University of Queensland/Blue Care Research and Practice Development Centre

### About the UQ/Blue Care Research & Practice Development Centre:

- The UQ/Blue Care Research and Practice Development Centre (RPDC) is a unique collaboration between research academics and industry professionals
- Our industry partner Blue Care, is Australia's largest not-for-profit provider of community health and residential aged care
- The RPDC is part of a global collaborative focused on generating research that translates into clinical practice
- The RPDC has supported research scholars enrolled in the Summer Research Scholarship, Honours, MPhil and PhD programs.
- Much of the research undertaken at the RPDC informs current health practice across aged and community settings
- The RPDC proactively seeks to provide opportunities to world class researchers and a diverse range of research projects
- The UQ/Blue Care RPDC hosts the Australian Centre for Evidence Based Community Care (ACEBCC) a Joanna Briggs Collaborating Centre

### Areas of Research

Research undertaken at the RPDC seeks to positively impact healthcare practices, the wider community and its members by:

- Developing evidence that will inform policy in relation to aged care, including age care provision, cost effectiveness, and outcome evaluation
- Investigating specific aged care clinical practice problems and evaluating the effectiveness of specific aged care strategies
- Identifying new models of service in response to changing community and client requirements with respect to aged care

### For further information contact:

UQ/Blue Care Research & Practice Development Centre  
E: v.percival@uq.edu.au  
T: +61 (0)7 3720 5308  
W: www.uq.edu.au/bluecare



## Australian Association of Gerontology

### Students and Early Career Researchers/Practitioners

The Australian Association of Gerontology (AAG) is Australia's leading and largest multi-disciplinary professional association with people working in the diverse field of ageing. Membership includes academics, practitioners, allied health professionals, students, researchers, policy makers, and other professionals working in ageing and aged care.

In addition to providing members with the latest information and news on ageing research through academic peer-reviewed journals, electronic newsletters, and trade journals, the AAG also runs educational events both locally and nationally including seminars, conferences, and workshops.

Furthermore, joining the AAG National Student and Early Career Group provides the following opportunities:

- Participate in educational, professional development and social events at the local and national level
- Network with other likeminded early career professionals through events and dedicated online communities
- Expand international connections and encourage the sharing of ideas and achievements
- Provide opportunities to connect with mid to late career professionals through informal networks and mentoring programs
- Access to discounted AAG Membership and the National Conference registration
- Develop leadership skills and help shape the future of the AAG

For more information, or to join the AAG, please visit: [www.aag.asn.au](http://www.aag.asn.au)



Don't forget to **LIKE** the "AAG Student and Early Career Group" on Facebook to stay connected

# Come to Sydney for **ERA 2013**



## **12<sup>th</sup> National Emerging Researchers in Ageing Conference**

**25-26 November 2013**  
**Sydney, NSW**

The 2013 ERA conference will be hosted by the Ageing, Work and Health Research Unit (AWHRU), Faculty of Health Sciences, The University of Sydney. The AWHRU finds ways of improving ageing experiences and enhancing the health of individuals and workers across the life span and includes research teams on: Ageing and Health; Participation, Safety and Ageing; and Work and Health. More information at [sydney.edu.au/health\\_sciences/ageing\\_work\\_health](http://sydney.edu.au/health_sciences/ageing_work_health).

More information about the conference including the venue and call for abstracts will be available at [www.era.edu.au/ERA+Conferences](http://www.era.edu.au/ERA+Conferences) early next year.

The conference will be held immediately prior to the Australian Association of Gerontology (AAG) conference in Sydney making it easy for participants to transition between the two conferences.



# Venue Map

## GROUND FLOOR

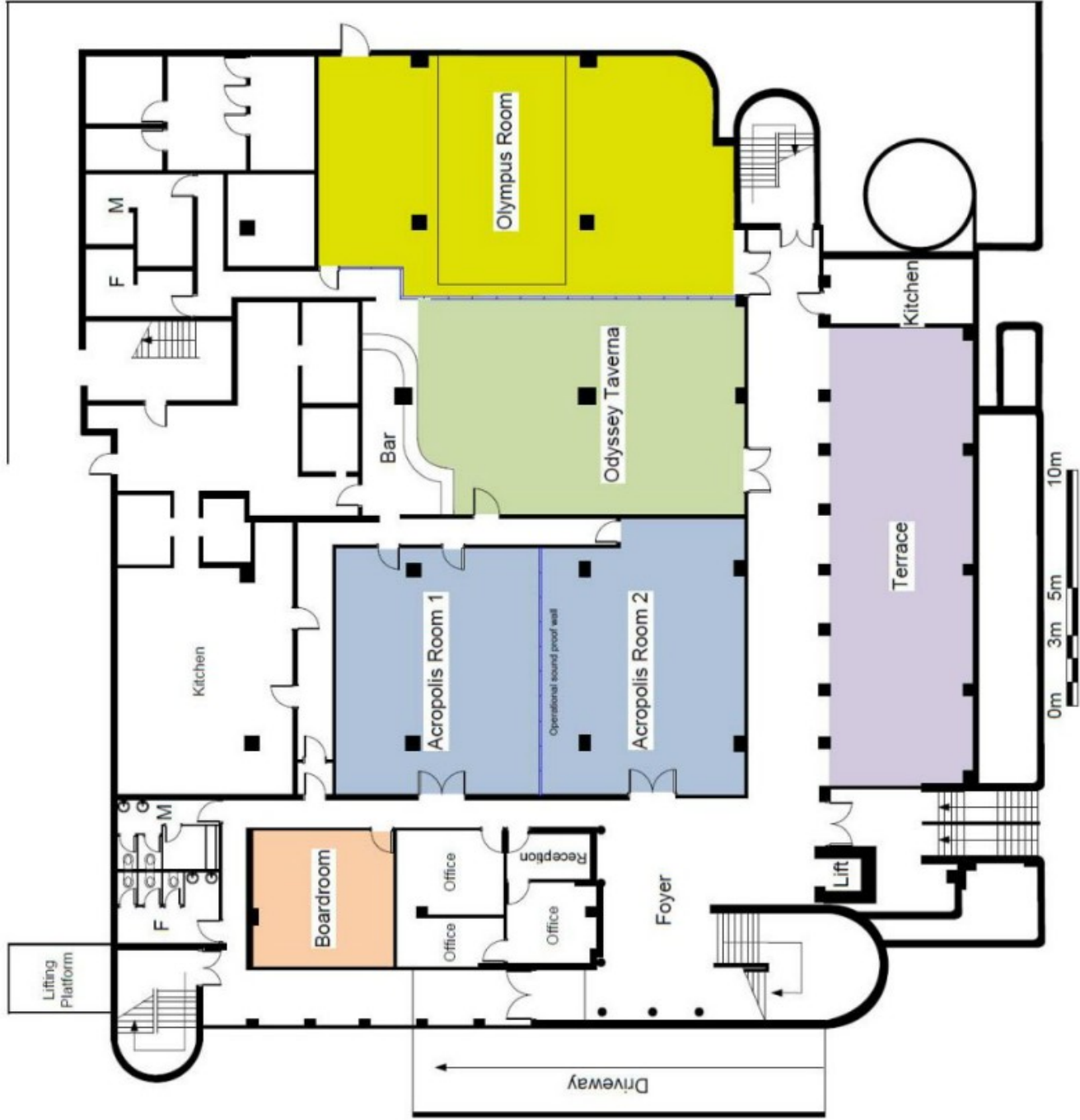

# Venue Map

## LEVEL ONE

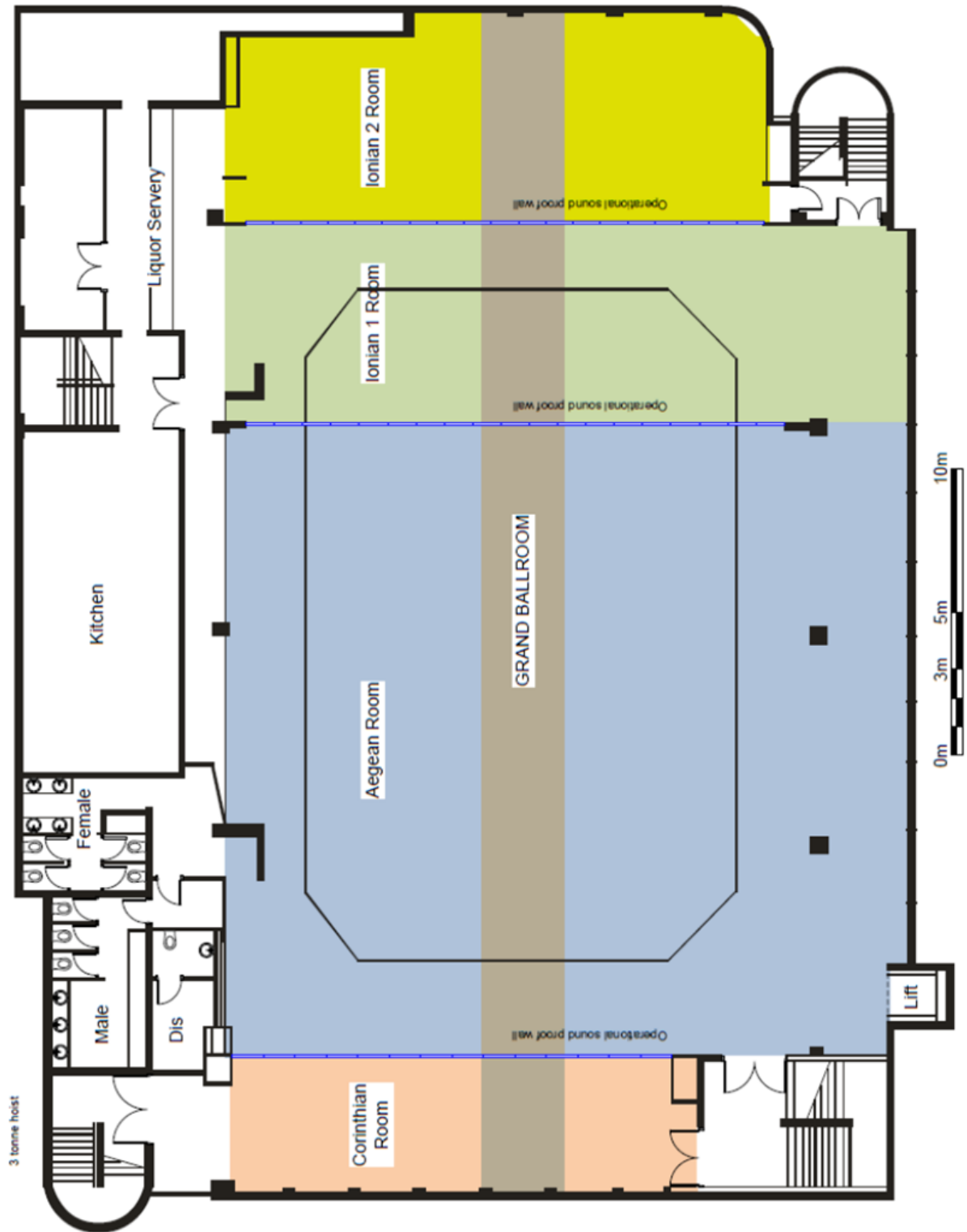





**The University of Queensland/  
Blue Care Research and Practice  
Development Centre**

**56 Sylvan Road  
Toowong Qld 4066  
Australia**

**Telephone: (07) 3720 5308  
Web: [www.uq.edu.au/bluecare](http://www.uq.edu.au/bluecare)**